

## Introduction

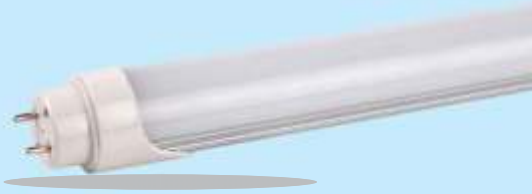

Our LED T8 tube integrates 3014SMD light source and a compact high efficiency driver into a traditional tube replacement. It employs a high-tech IC solution to ensure the good stability. The 6063 aluminium heat sink guarantees good heat dissipation. One-end power design for safe installation.

- Up to 70% energy saving compared to traditional tube
- Long lifetime of 40,000 hours
- 120° wide beam angle
- 1200mm length
- CCT: 2800K-3000K 4000K-4500K  
5500K-6000K 6000K-6500K
- No UV/IR light
- Environment friendly, without Mercury or any other hazardous substances

### Application notes

- IP40 for indoor use only
- The lamp must be installed by professional electrician
- Turn off before installation, in case of electronic shock
- Do not touch the lamp when in use
- Keep away from hot steam and corrosive gas

### Certificates



LED TUBE 1200mm (4ft) - 22Watt

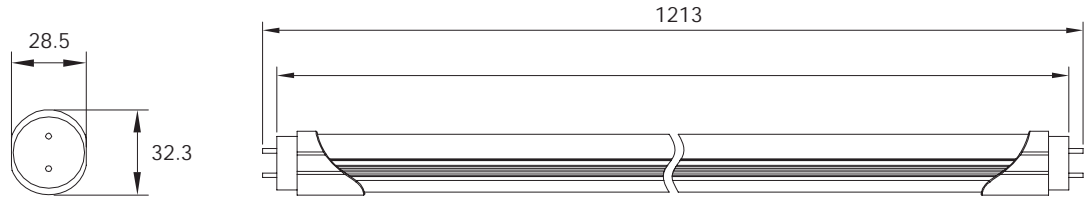

Model	Voltage	Power	Power Factor	Lumen (±5%)	Beam angle	CCT	Lifespan	CRI	Dimmable	Dimension
TUBE-1200-22W	AC200-265V	22W	?	2035	120°	6000K	40000hs	?	Yes	L1213*W28.5*H32.3mm

### Driver Data Sheet

Driver data	DIM	Non-dim
Input Voltage	AC200-265V	AC100-240V
Frequency	50Hz	50-60Hz
Input rated Voltage	AC230V	AC230V
Efficiency	?	?
No load wattage	?:	?:
Total load Wattage	22W±1W	22W±1W
Power Factor	?	?
Rated input current	? \$	? \$
No load output Voltage	DC46V	DC46V
No load output Voltage range	DC40-48V	DC40-48V
Full load output Voltage	'&9	'&9
Rated output current	500mA	520mA
Output current range	430mA±5%	480mA±5%
Tolerance	±5%	±5%
Current output tolerance	±5%	±5%
Dimming range	8%-100%	—
Dimmer	Triac dimmers	—
Withstand voltage	AC3750V	AC3750V

### Fixture Compatibility

Rated Wattage	Electrical Classification	Ingress Protection (IP)	Operating Temp	Operating Humidity	Storage Temp
22W	II	40	-10°C-45°C		-20°C-65°C

LED TUBE 1200mm (4ft) - 22Watt

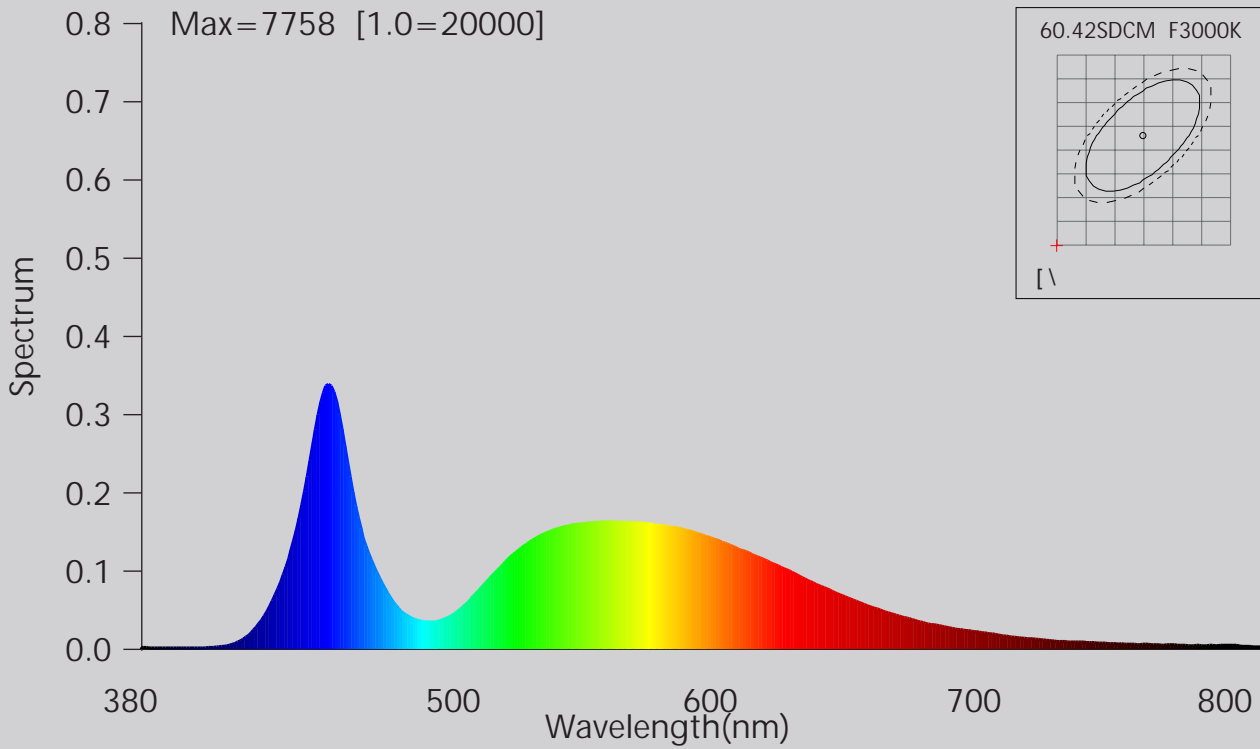

## Photometric Diagram

Polar intensity diagram

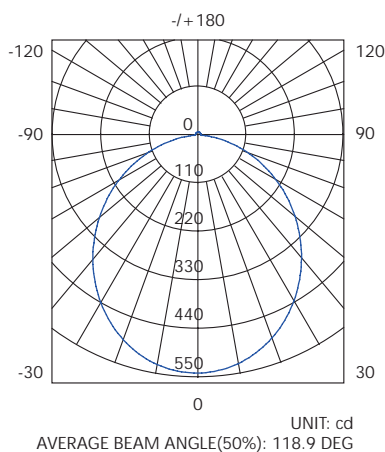

Cartesian intensity diagram

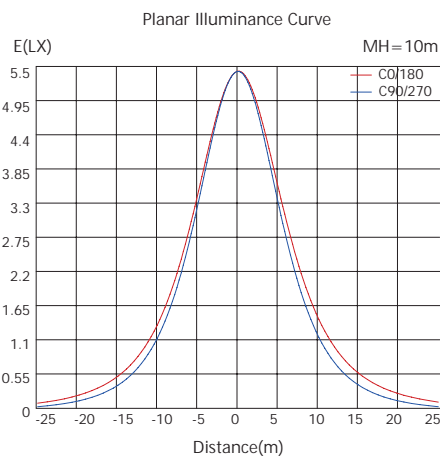

Beam diagram

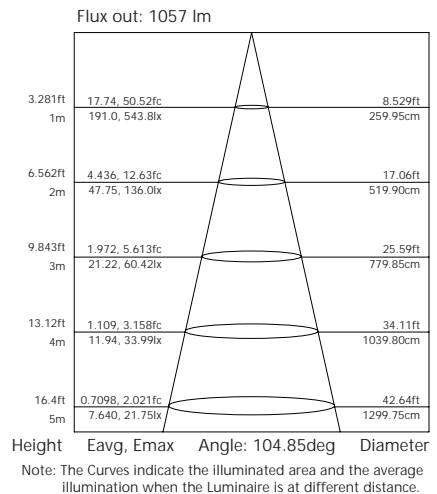

## Polar Diagram Comparison

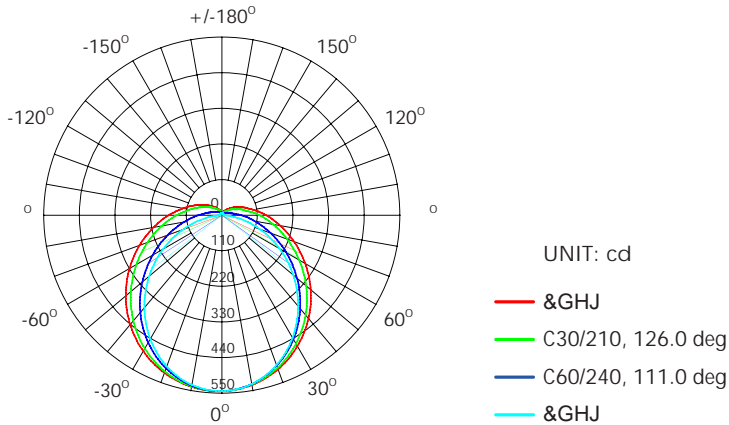

\$9(5\$\*(%(\$0\$1\*/('(\*

## Driver lifetime & LED lifetime

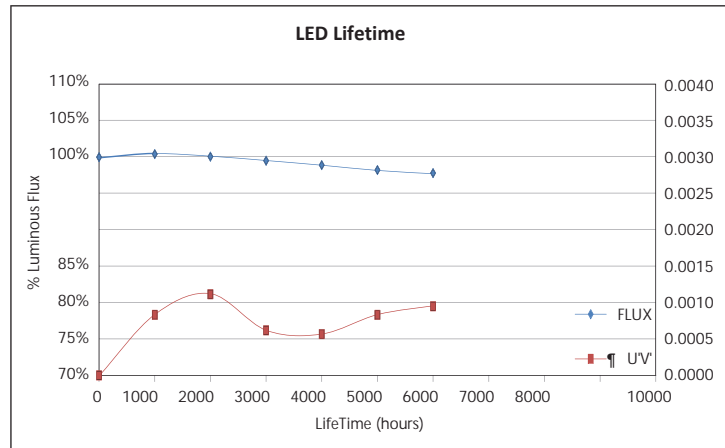
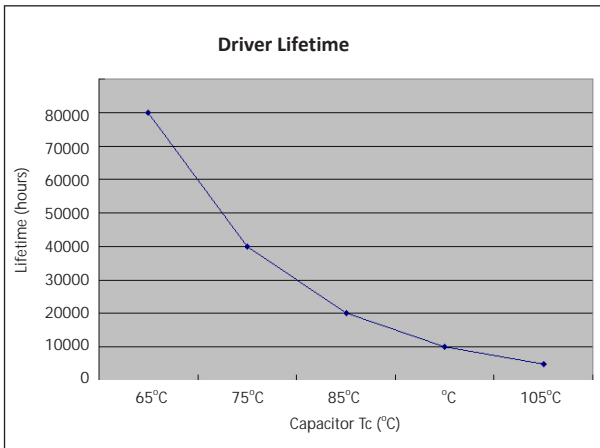

The testing is operated at 35°C environment temperature.

- The minimum lifetime for capacitor is 5000hours at 105°C, the lifetime will be double when the temperature drop each 10°C. The highest withstand temperature of IC is 120°C
- The highest withstand temperature of MOS is 120°C
- The highest withstand LED junction temperature is 120°C

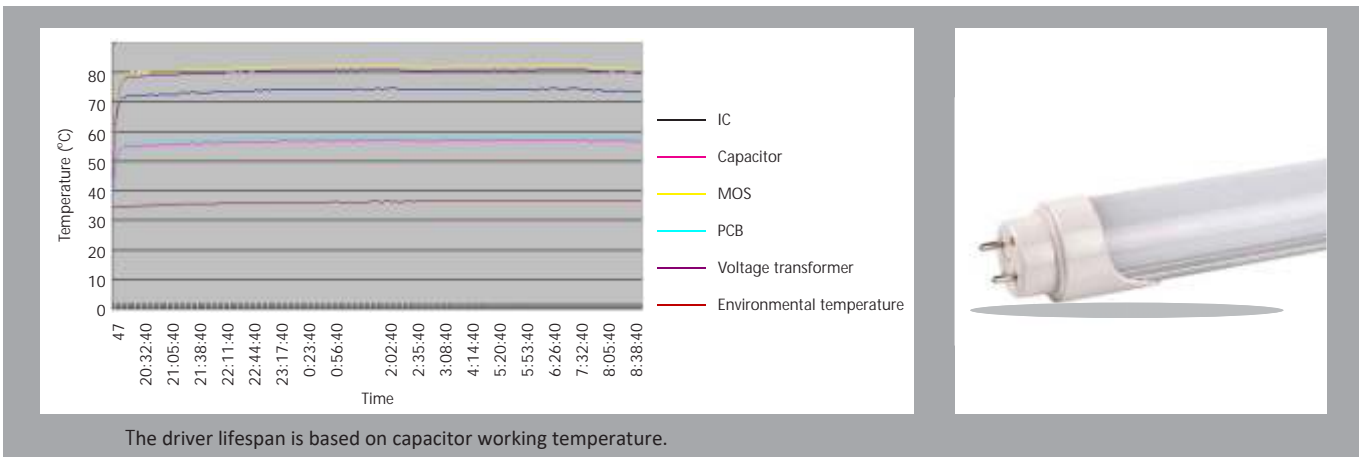

LED TUBE 1200mm (4ft) - 22Watt

## Installation

### 1. One end power tube, installation with Electric Ballast

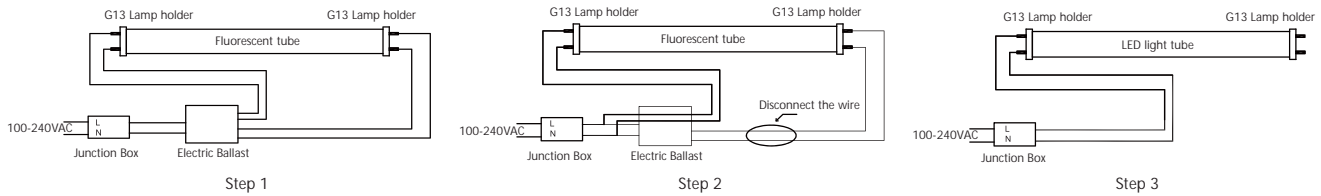

### 2. One end power tube, installation with Inductive Ballast

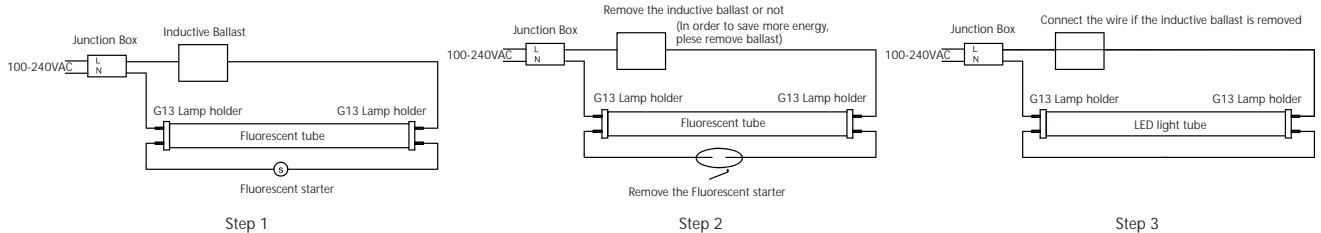

LED TUBE 1200mm (4ft) - 22Watt